



# Public Notice

U.S. Army Corps  
of Engineers  
Pittsburgh District

In Reply Refer to  
Notice No. below

US Army Corps of Engineers, Pittsburgh District  
1000 Liberty Avenue  
Pittsburgh, PA 15222-4186

Application No. 2008-280

Date: August 12, 2009

Notice No. 09-38

Closing Date: September 2, 2009

1. TO ALL WHOM IT MAY CONCERN: The following application has been submitted for a Department of the Army Permit under the provisions of Section 404 of the Clean Water Act.
2. APPLICANT: Glacial Sand and Gravel Company  
P.O. Box 1022  
Kittanning, Pennsylvania 16201  
  
AGENT: The EADS Group, Incorporated  
Clarion Office  
15392 Route 322  
Clarion, Pennsylvania 16214
3. LOCATION: 1.7 miles west of the Borough of West Liberty, along West Liberty Road in Worth Township, Butler County, Pennsylvania
4. PURPOSE AND DESCRIPTION OF WORK: The applicant proposes to construct a sand and gravel processing plant to wash and screen various grades of aggregate material and stockpile this material on site. The purpose of the plant is for the associated ponds to provide adequate water supply to be used as wash water and to allow for re-cycling of water. To facilitate construction of the plant and ponds the applicant proposes to fill 1.89 acres of wetland and approximately 240 linear feet of stream. Approximately 50 linear feet of stream has already been impacted for the construction of a 24" diameter culvert crossing to gain access to the site. An additional 0.01 acres of wetland and 10 linear feet of stream will be temporarily disturbed for the installation of a sanitary sewer line. To mitigate the loss of both wetland and stream function, two acres of wetland will be created north of West Liberty Road and south of the large existing wetland which will not be disturbed as a result. Drawings of the proposed project are attached to this notice.
5. ENCROACHMENT PERMIT: The applicant must obtain a Water Obstruction and Encroachment Permit which includes 401 Water Quality Certification from the:

Pennsylvania Department of Environmental Protection  
Northwest Regional Office

Soils and Waterways Section  
230 Chestnut Street  
Meadville, Pennsylvania 16335

Telephone: 814-332-6984

6. IMPACT ON NATURAL RESOURCES: The District Engineer has consulted the most recently available information and has determined that the project is not likely to affect the continued existence of any endangered species or threatened species, or result in the destruction or adverse modification of habitat of such species which has been determined to be critical. This Public Notice serves as a request to the U. S. Fish and Wildlife Service for any additional information they may have on whether any listed or proposed to be listed endangered or threatened species may be present in the area which would be affected by the activity, pursuant to Section 7(c) of the Endangered Species Act of 1972 (as amended).

7. IMPACT ON CULTURAL RESOURCES: The National Register of Historic Places has been consulted, and it has been determined that there are no properties currently listed on the register which would be directly affected by the proposed work. If we are made aware, as a result of comments received in response to this notice, or by other means, of specific archeological, scientific, prehistorical, or historical sites or structures which might be affected by the proposed work, the District Engineer will immediately take the appropriate action necessary pursuant to the National Historic Preservation Act of 1966 - Public Law 89-665 as amended (including Public Law 96-515).

8. PUBLIC INVOLVEMENT: Any person may request, in writing, within the comment period specified in the paragraph below entitled "RESPONSES," that a public hearing be held to consider this application. The requests for public hearing shall state, with particularity, the reasons for holding a public hearing.

9. EVALUATION: Interested parties are invited to state any objections they may have to the proposed work. The decision whether to issue a permit will be based on an evaluation of the probable impact including cumulative impacts of the proposed activity on the public interest. That decision will reflect the national concern for both protection and utilization of important resources. The benefit which reasonably may be expected to accrue from the proposals must be balanced against its reasonably foreseeable detriments. All factors which may be relevant to the proposal will be considered including the cumulative effects thereof; among those are conservation, economics, aesthetics, general environmental concerns, wetlands, historic properties, fish and wildlife values, flood hazards, flood plain values, land use, navigation, shoreline erosion and accretion, recreation, water supply and conservation, water quality, energy needs, safety, food and fiber production, mineral needs, considerations of property ownership and, in general, the needs and welfare of the people. The Corps of Engineers is soliciting comments from the public; Federal, state, and local agencies and officials; Indian Tribes; and other interested parties in order to consider and evaluate the impacts of this proposed activity.

Any comments received will be considered by the Corps of Engineers to determine whether to issue, modify, condition or deny a permit for this proposal. To make this decision, comments are used to assess impacts on endangered species, historic properties, water quality, general environmental effects, and the other public interest factors listed above. Comments are used in the preparation of an Environmental Assessment and/or an Environmental Impact Statement pursuant to the National Environmental Policy Act. Comments are also used to determine the overall public interest of the proposed activity. The evaluation of the impact of the activity on the public interest will include application of the guidelines promulgated by the Administrator, Environmental Protection Agency, under the authority of Section 404(b) of the Clean Water Act (40 CFR Part 230).

10. RESPONSES: A permit will be granted unless its issuance is found to be contrary to the public interest. Written statements concerning the proposed activity should be received in this office on or before the closing date of this Public Notice in order to become a part of the record and to be considered in the final determination. Any objections which are received during this period may be forwarded to the applicant for possible resolution before the determination is made whether to issue or deny the requested DA Permit. All responses to this notice should be directed to the Regulatory Branch, attn Tyler Bintrim at the above address, by telephoning (412) 395-7115, or by e-mail at tyler.j.bintrim@usace.army.mil. Please refer to CELRP-OP-F 2008-280 in all responses.

FOR THE DISTRICT ENGINEER:

//SIGNED//

Scott A. Hans  
Chief, Regulatory Branch

080° 06' 0.00" W

080° 05' 0.00" W

080° 04' 0.00" W

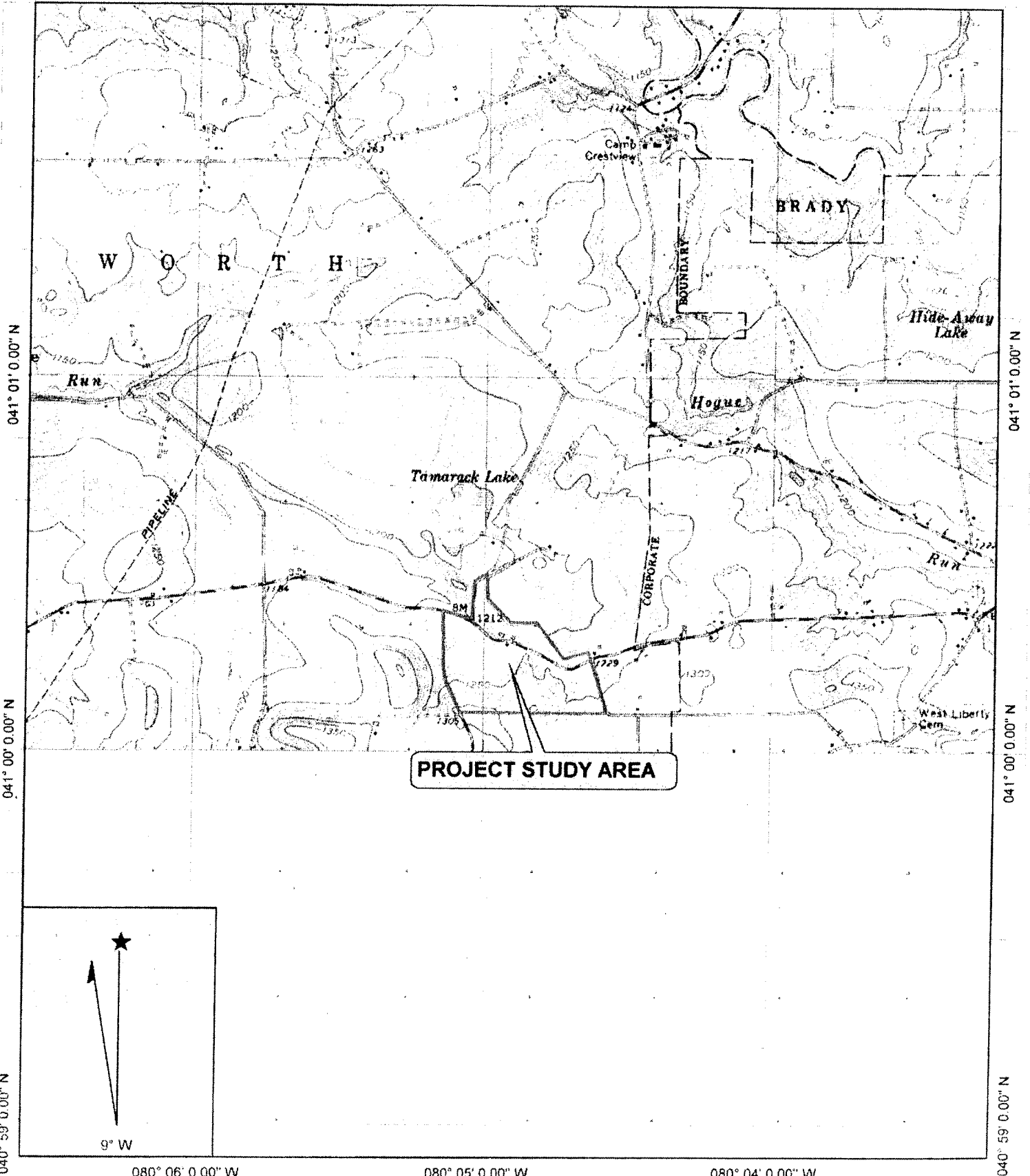

**PROJECT STUDY AREA**

Name: SLIPPERY ROCK  
 Date: 1/23/2008  
 Scale: 1 inch equals 2000 feet

Location: 041° 00' 27.24" N 080° 04' 53.88" W  
 Caption: Glacial Sand and Gravel Co.  
 Mine 47 SMP  
 Worth Township, Butler County

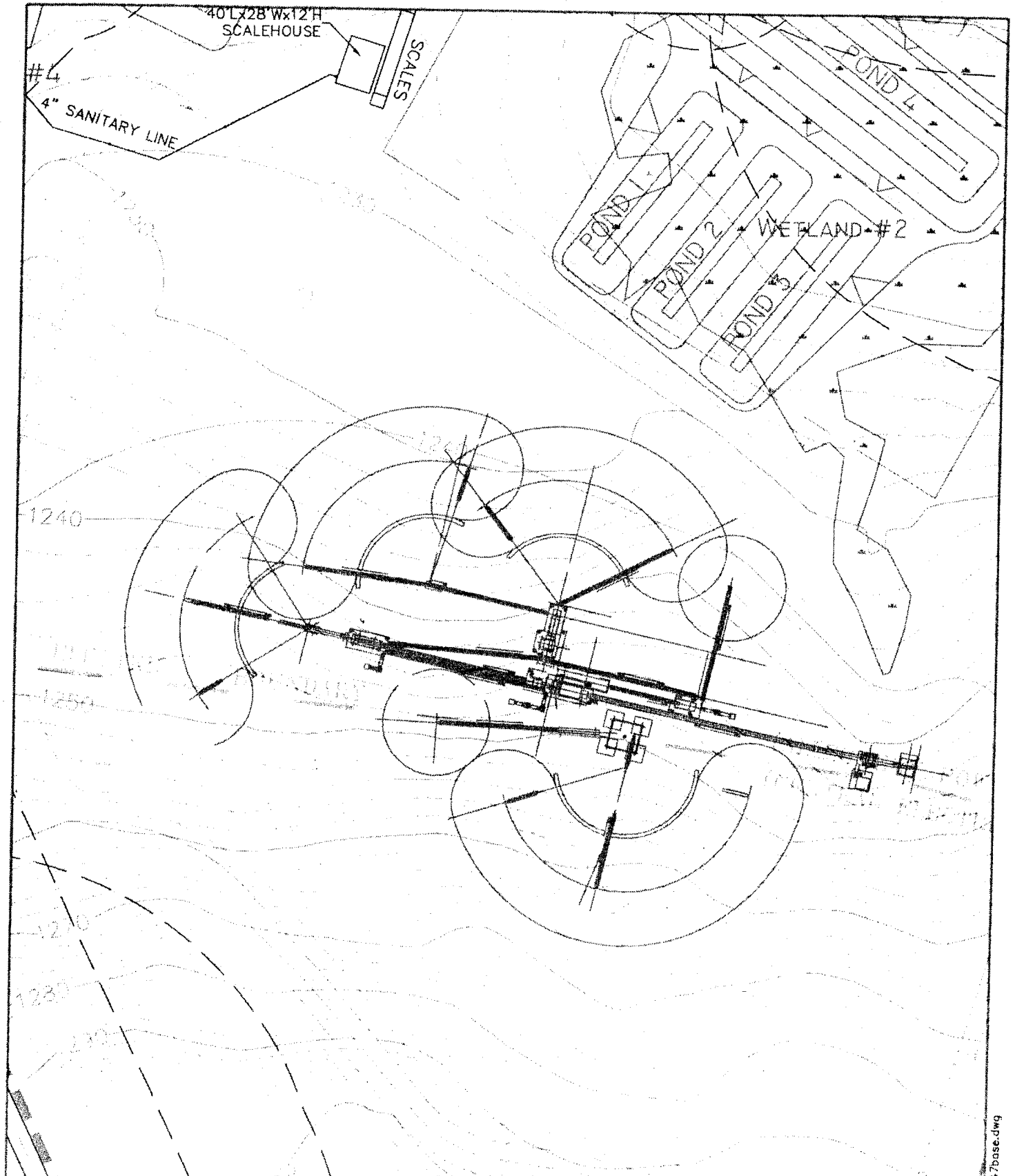

**THE  
EADS  
GROUP**  
ENGINEERING ARCHITECTURE AND DESIGN SERVICES

CLARION OFFICE  
15392 Route 322  
CLARION, PA 16214  
(814) 764-5050  
(814) 764-5055 FAX  
EMAIL: clarion@eadsgroup.com

GLACIAL SAND AND GRAVEL CO.  
P.O. BOX 1022  
KITANNING, PA 16201

WORTH TOWNSHIP

BUTLER COUNTY

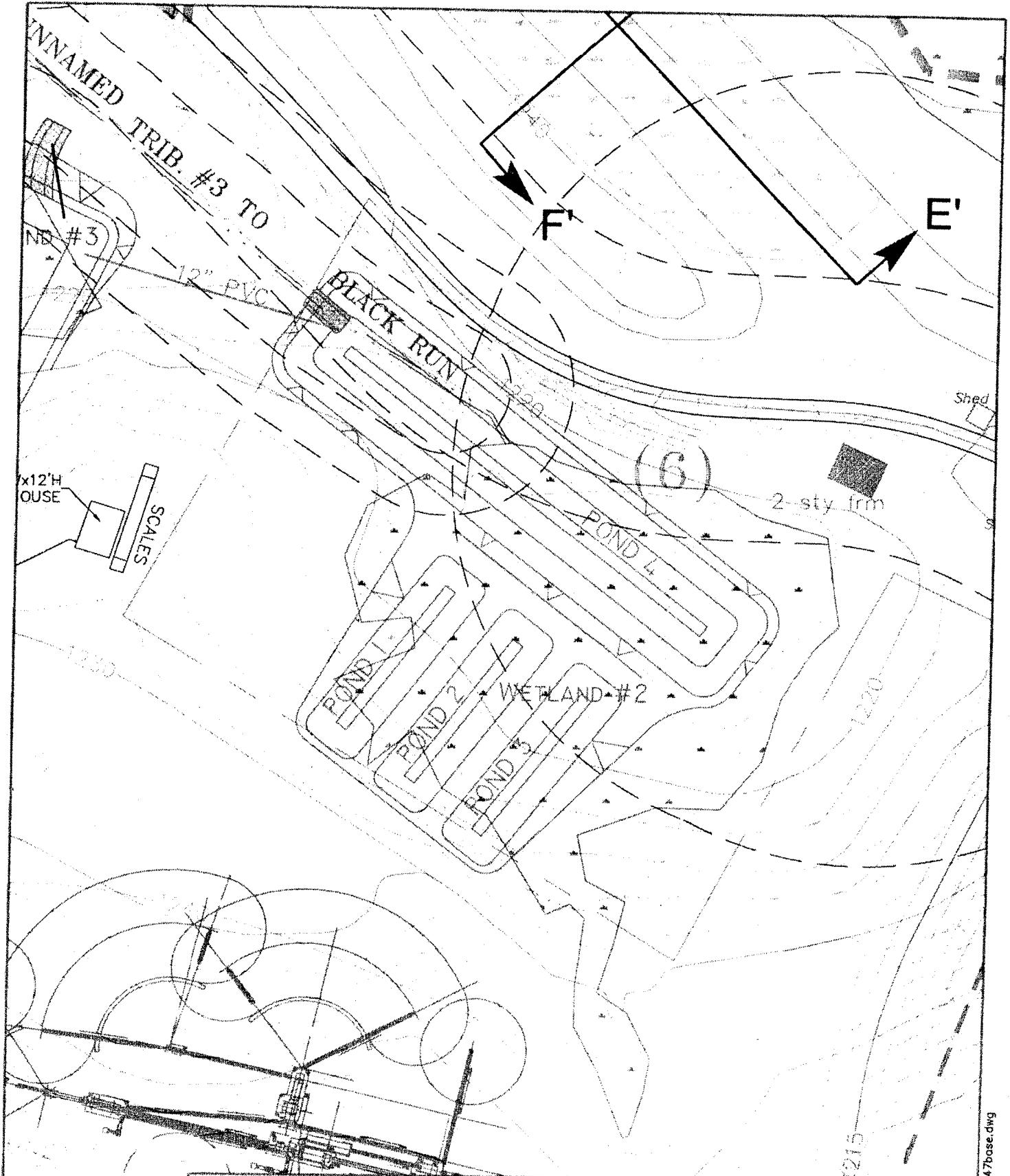

**THE EADS GROUP**  
 ENGINEERING ARCHITECTURE AND DESIGN SERVICES

CLARION OFFICE  
 15392 Route 322  
 CLARION, PA 16214  
 (814) 764-5050  
 (814) 764-5055 FAX  
 EMail: clarion@eadsgroup-clarion.com

GLACIAL SAND AND GRAVEL CO.  
 P.O. BOX 1022  
 KITTANNING, PA 16201

WORTH TOWNSHIP  
 BUTLER COUNTY

DWG NAME: Mine47base.dwg

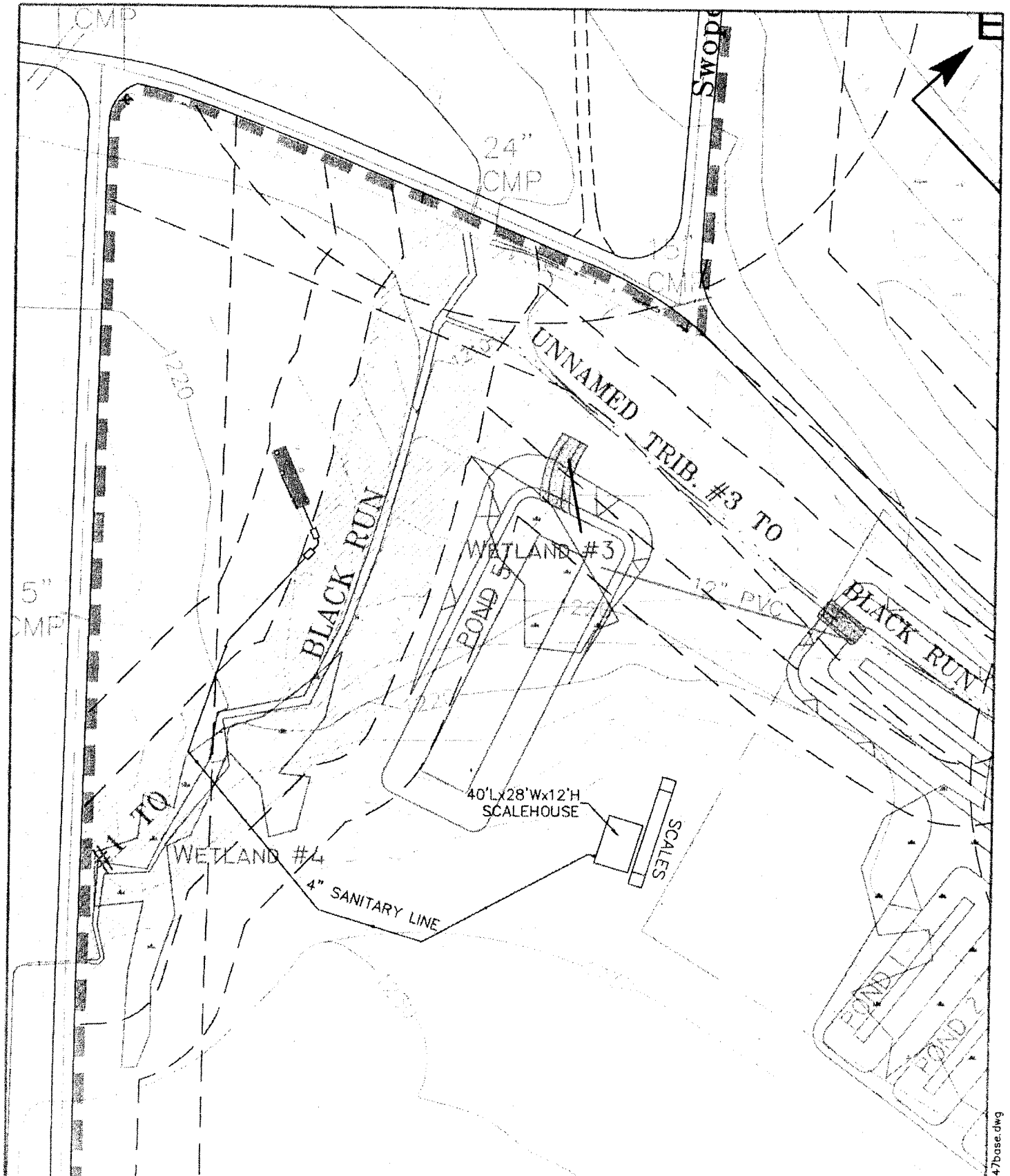

**THE EADS GROUP**  
 ENGINEERING ARCHITECTURE AND DESIGN SERVICES

CLARION OFFICE  
 15392 Route 322  
 CLARION, PA 16214  
 (814) 764-5050  
 (814) 764-5055 FAX  
 URL: clarion@eadsgroup-clarion.com

GLACIAL SAND AND GRAVEL CO.  
 P.O. BOX 1022  
 KITTANNING, PA 16201

WORTH TOWNSHIP BUTLER COUNTY

DWG NAME: Mine47base.dwg

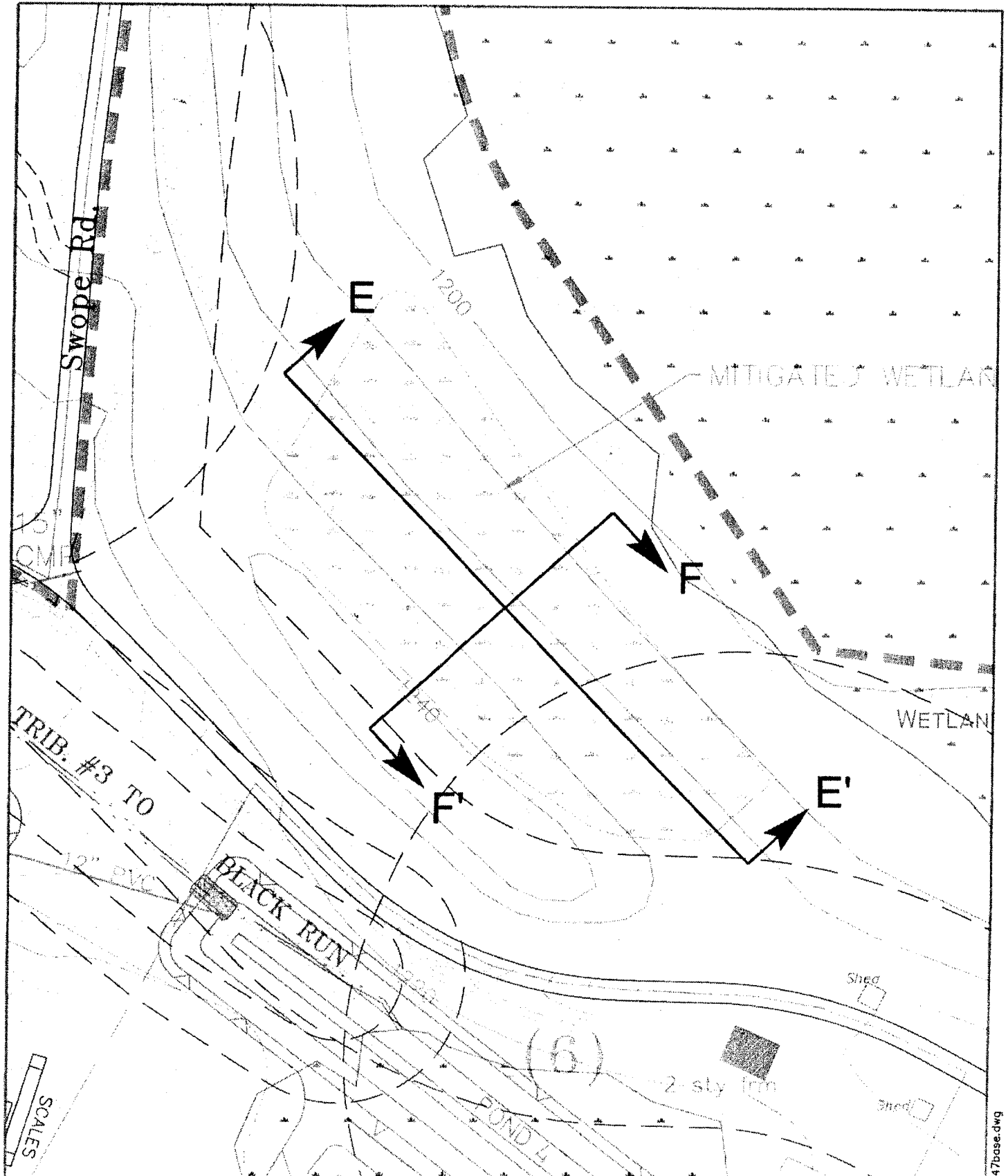

**THE EADS GROUP**  
 ENGINEERING ARCHITECTURE AND DESIGN SERVICES

CLARION OFFICE  
 15392 Route 322  
 CLARION, PA 16214  
 (814) 764-5050  
 (814) 764-5055 FAX  
 URL: [data@eadsgroup.com](http://data@eadsgroup.com)

**GLACIAL SAND AND GRAVEL CO.**  
 P.O. BOX 1022  
 KITTANNING, PA 16201

WORTH TOWNSHIP BUTLER COUNTY

DWG NAME: Mine47base.dwg