

# MAP 1

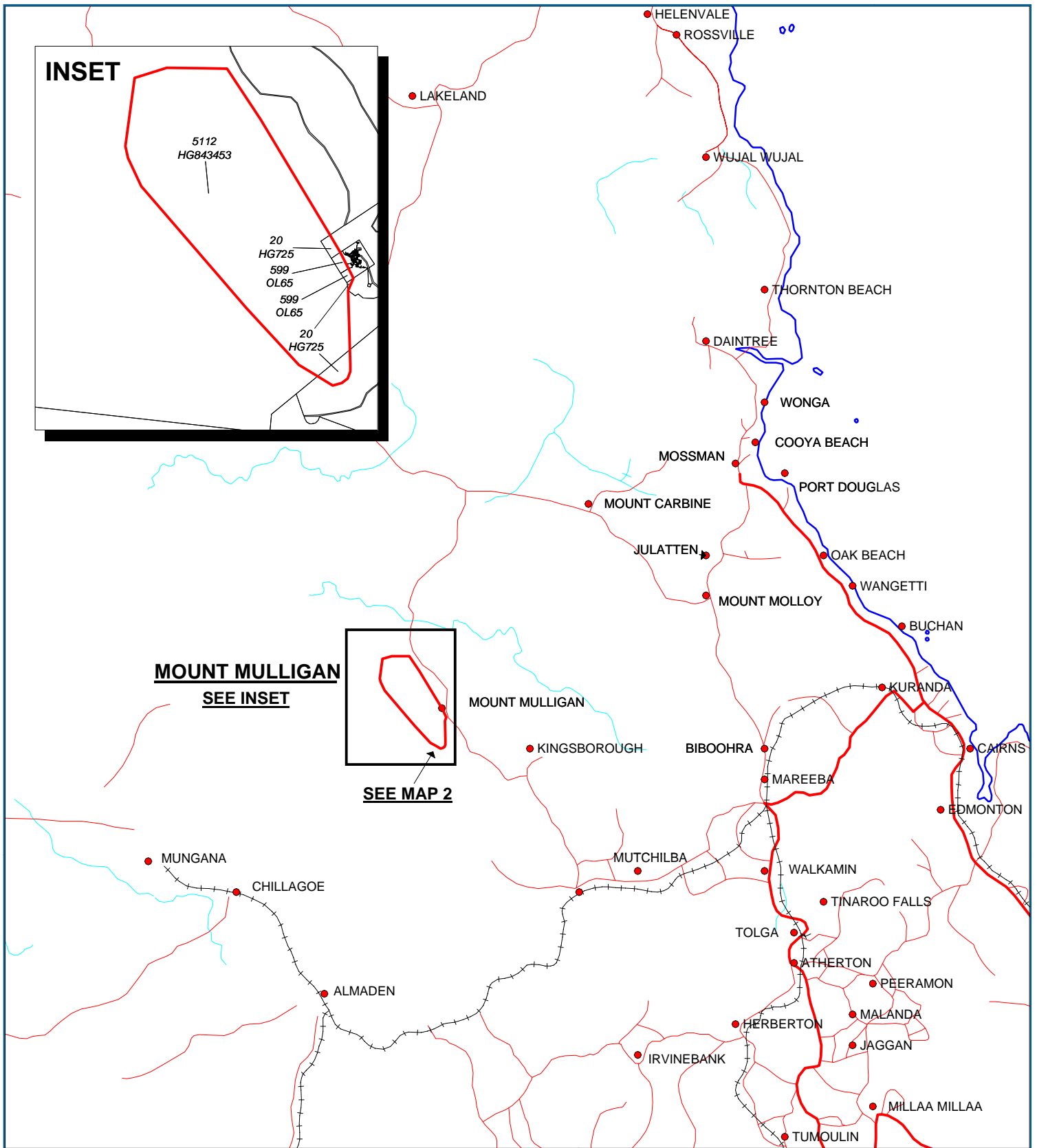

**REGISTERED AREA**  
**MOUNT MULLIGAN ABORIGINAL CULTURAL HERITAGE AREA**  
 See "Aboriginal Cultural Heritage Act 2003" Part 5 Div 2  
**LOCATION:- 144 °19' 02" -16 °50' 05"**  
 Part of Lot 5112 Plan HG843453,  
 Lot 20 Plan HG725, and Lot 599 Plan OL65  
**Tablelands Regional Council**

Map Projection : Geographical latitude and longitude GDA94.  
 Compilation : Land Tenure Information obtained from the Digital Cadastre Data Base Dept of Environment and Resource Management Brisbane. The Land Registry in the Dept of Environment and Resource Management should be consulted for verification of tenures.  
 Feature names shown on this map have been obtained from available information. It is possible that errors and omissions may exist.  
 The Dept of Environment and Resource Management disclaims any liability for any errors or omissions that appear in this document.  
 Copyright protects this publication. Except for purposes permitted by the Copyright Act, reproduction by whatever means is prohibited without the prior written permission of the Dept of Environment and Resource Management.  
 Inquiries should be addressed to the Director-General, GPO Box 2454, Brisbane, 4001, QUEENSLAND, AUSTRALIA.  
 MAP PRODUCED BY CULTURAL HERITAGE COORDINATION UNIT, DEPARTMENT OF ENVIRONMENT AND RESOURCE MANAGEMENT, BRISBANE.  
 © THE STATE OF QUEENSLAND (DEPT OF ENVIRONMENT AND RESOURCE MANAGEMENT) 28 JANUARY 2009

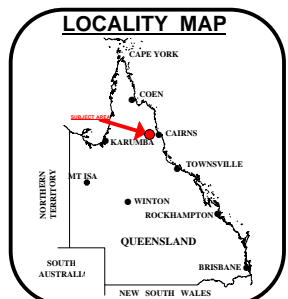

# MAP 2

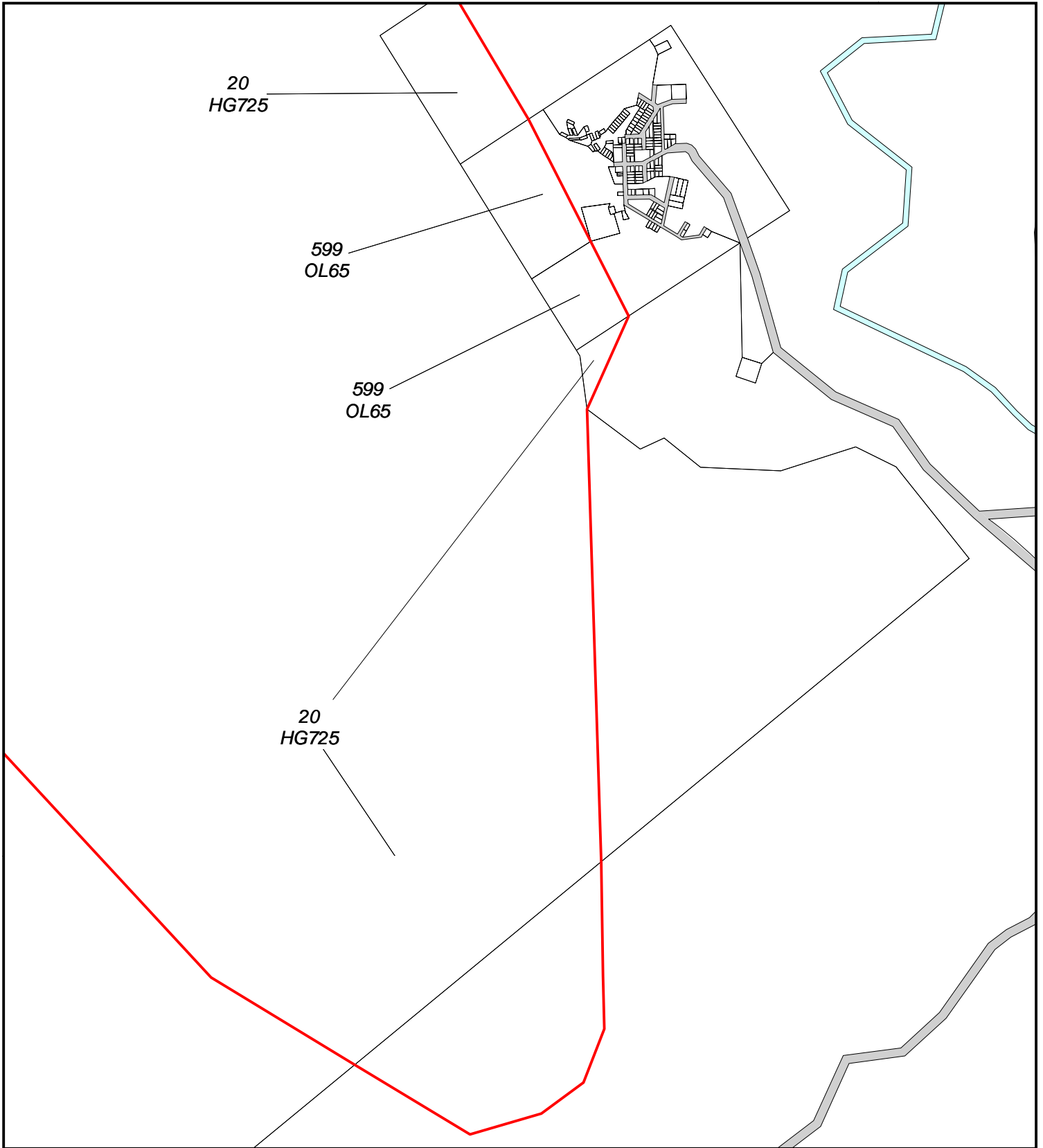

**REGISTERED AREA**  
**MOUNT MULLIGAN ABORIGINAL**  
**CULTURAL HERITAGE AREA**  
 See "Aboriginal Cultural Heritage Act 2003"  
 Part 5 Div 2  
**LOCATION:- 144 °19' 02" -16 °50' 05"**  
 Part of Lot 5112 Plan HG843453,  
 Lot 20 Plan HG725, and Lot 599 Plan OL65  
**Tablelands Regional Council**

Map Projection : Geographical latitude and longitude GDA94.  
 Compilation : Land Tenure Information obtained from the Digital Cadastre Data Base  
 Dept of Environment and Resource Management Brisbane. The Land Registry in the  
 Dept of Environment and Resource Management should be consulted for verification of tenures.  
 Feature names shown on this map have been obtained from available information.  
 It is possible that errors and omissions may exist.  
 The Dept of Environment and Resource Management disclaims any liability for any errors or  
 omissions that appear in this document.  
 Copyright protects this publication. Except for purposes permitted by the Copyright  
 Act, reproduction by whatever means is prohibited without the prior written permission  
 of the Dept of Environment and Resource Management.  
 Inquiries should be addressed to the Director-General, GPO Box 2454, Brisbane,  
 4001, QUEENSLAND, AUSTRALIA.  
 MAP PRODUCED BY CULTURAL HERITAGE COORDINATION UNIT,  
 DEPARTMENT OF ENVIRONMENT AND RESOURCE MANAGEMENT, BRISBANE.  
 © THE STATE OF QUEENSLAND (DEPT OF ENVIRONMENT AND RESOURCE MANAGEMENT) 28 JANUARY 2009

